



**ASBESTOS CONTAINING MATERIAL SURVEY REPORT
OF
HISTORIC SUPERIOR HIGH SCHOOL CAMPUS**

**FUNDED BY: COPPER CORRIDOR BLIGHT BUSTERS BROWNFIELDS
COALITION ASSESSMENT GRANT**



**98 NORTH HIGH SCHOOL AVENUE
SUPERIOR, PINAL COUNTY, ARIZONA 85173
APN: 106-09-025Q**

ATLAS PROJECT NO. 1052000242, PHASE 3

REPORT DATE: OCTOBER 13, 2022

Prepared by:

Atlas Technical Consultants LLC
9185 South Farmer Road, Suite 111
Tempe, Arizona 85284
Phone: (480) 894-2056
Fax: (480) 894-2497

Prepared for:

Copper Corridor Blight Busters
Brownfields Coalition
1400 East Ash Street
Globe, Gila County, Arizona 85501
Phone: (928) 402-4392

Project Responsibility

This report has been prepared consistent with good customary industry practices for the evaluation of asbestos-containing materials (ACM) in structures scheduled for renovation. Atlas Technical Consultants LLC (Atlas) presents the data from this Asbestos Survey, based on the conditions observed during the site survey conducted between July 19 to July 29, 2022. Atlas makes no determinations and warrants no conclusions beyond those stated herein. Further, Atlas submits this report to Copper Corridor Blight Busters Brownfields Coalition (CC BB Brownfields Coalition) for the exclusive use of CC BB Brownfields Coalition.

Atlas appreciates this opportunity to assist CC BB Brownfields Coalition with this project. Thank you for allowing our firm to perform these consulting services. Your business is important to us and we sincerely appreciate your patronage. Please contact the undersigned if you have any questions or need additional information.

This survey was completed by:



McKenzie Wenger, Environmental Staff Scientist
Email: mckenzie.wenger@oneatlas.com
AHERA Asbestos Building Inspector
ON-4644-12813-010422



Chad Wells, Industrial Hygiene Technician
Email: chad.wells@oneatlas.com
AHERA Asbestos Building Inspector
ON-4649-12331-111521

This report was reviewed by:

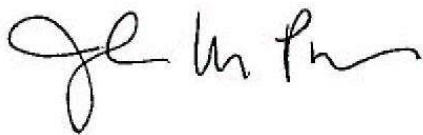

Julie Powers, Due Diligence Department Manager
Email: julie.powers@oneatlas.com
Direct Line: 480-355-4620



Robyn Steiner, Industrial Hygiene Manager, CIH CSP
Email: robyn.steiner@oneatlas.com
Direct Line: 480-355-4633

Executive Summary

The Copper Corridor Blight Busters Brownfields Coalition (CC BB Brownfields Coalition) authorized Atlas Technical Consultants LLC (Atlas) to conduct an Asbestos Survey, collectively referred to as “the Survey,” of seven (7) buildings that make up the historic Superior High School campus; hereinafter, referred to as the Site. The purpose of the Survey was to determine the asbestos content of suspect asbestos-containing materials (ACMs) that may be impacted by future renovations, additions or demolitions of the structures at the Site.

Mr. Chad Wells, Ms. McKenzie Wenger, Ms. Kendell Carlson, and Ms. Rhobeca Sweat, Atlas Asbestos Hazard Emergency Response Act (AHERA) accredited building inspectors, conducted this survey from July 19 to July 29, 2022. A summary of the identified ACM for Buildings 1, 3, 4, 5, 6, and 7 at the Site during Atlas’ Survey are noted in Tables E-1 through E-6 below. ACM was not identified in the materials tested from Building 2.

Table E-1: Identified ACM Historic Superior High School Campus – Building 1

Summary of Identified ACM Former Superior High School Campus – Building 1 98 North High School Avenue Superior, Arizona 85173 Survey Date: July 19, 2022							
Sample No.	Homogenous Material	Material Location	Asbestos Content	Friable	Condition	Quantity	NESHAP Category
1-M2-A 1-M2-B 1-M2-C	Transite Panel	Chalkboard – East Wall	8% Chrysotile	No	Good	40 SF	CAT II
<small>% = Percent; SF = Square Feet; CAT I = Category I Non-Friable ACM; CAT II = Category II Non-Friable ACM; RACM = Regulated Asbestos Containing Material; ND = Non-detect</small>							

Table E-2: Identified ACM Historic Superior High School Campus – Building 3

Summary of Identified ACM Historic Superior High School Campus – Building 3 98 North High School Avenue Superior, Arizona 85173 Survey Date: July 20 and 21, 2022							
Sample No.	Homogenous Material	Material Location	Asbestos Content	Friable	Condition	Quantity	NESHAP Category
3-F1-A 3-F1-B 3-F1-C	12"x12" Vinyl Floor Tile (VFT) and Mastic – Beige Mottled with Black Mastic	Classrooms 1, 2, 3, and 4, Corridor	VFT PLM: ND VFT TEM: ND Mastic: 3% Chrysotile	No	Good	8,000 SF	CAT II
3-F3-A 3-F3-B 3-F3-C	9"x9" VFT and Mastic – Beige Mottled with Black Mastic	Closet, Office (Under HA-F2), Partition between Classrooms 3 and 4	VFT: 4% Chrysotile Mastic: 5% Chrysotile	No	Good	550 SF	CAT II
3-M1-A 3-M1-B 3-M1-C	Door Frame Sealant – White	Doors Throughout	5% Chrysotile	No	Good	65 SF	CAT II
3-M3-A 3-M3-B 3-M3-C	Transite Panel Boards (Chalkboards)	Classrooms 1, 2, 3, and 4	10% Chrysotile	Np	Good	500 SF	CAT II
3-M5-A 3-M5-B 3-M5-C	Window Frame Sealant – White	Perimeter Windows	5% Chrysotile	NO	Good	135 SF	CAT II
3-M10-A 3-M10-B 3-M10-C	2" Duct Seam Tape – Paper-like	Plenum – Ductwork Under Duct Wrap Insulation	60% Chrysotile	No	Good	100 SF	RACM
<small>% = Percent; SF = Square Feet; CAT I = Category I Non-Friable ACM; CAT II = Category II Non-Friable ACM; RACM = Regulated Asbestos Containing Material; ND = Non-detect; VFT=Vinyl Floor Tile; PLM=Polarized Light Microscopy; TEM= Transmission Electron Microscopy</small>							

Table E-3: Identified ACM Historic Superior High School Campus – Building 4

Summary of Identified ACM Historic Superior High School Campus – Building 4 98 North High School Avenue Superior, Arizona 85173 Survey Dates: July 22 and 25, 2022							
Sample No.	Homogenous Material	Material Location	Asbestos Content	Friable	Condition	Quantity	NESHAP Category
4-F11-A 4-F11-B 4-F11-C	12"x12" VFT and Mastic – Pink with Red and White Mottling (Floor Patch)	Storage 2	VFT PLM: ND VFT TEM: 1.56% Chrysotile Mastic: ND	No	Good	6 SF	CAT II
4-F12-A 4-F12-B 4-F12-C	9"x9" VFT and Mastic – Gray with White and Dark Gray Streaks and Black Mastic	Vending Machine Room – East Half	VFT PLM: ND VFT TEM: 1.55% Chrysotile Mastic: ND	No	Good	100 SF	CAT II
4-F20-A 4-F20-B 4-F20-C	9"x9" VFT and Mastic – Tan with Black and White Streaks and Black Mastic	Storage 5	VFT: 5% Chrysotile Mastic: ND	No	Good	150 SF	CAT II
4-W7-A 4-W7-B 4-W7-C	Popcorn Textured Plaster Walls	Reception Area (Upper Portion of Walls)	3% Chrysotile	Yes	Good	200 SF	RACM
4-W13-A 4-W13-B 4-W13-C	Acoustical Wall Panels – Wheat board with Brown Adhesive	Gym, Locker Halls 1 and 2	Wall Panels: ND Brown Adhesive: 2% Chrysotile	No	Good	850 SF	CAT II
4-C2-F 4-C2-G 4-C2-H	Orange-peel Textured Plaster Ceiling	Men's Restroom	PC: 2% Chrysotile	No	Good	250 SF	RACM
4-M7-A 4-M7-B 4-M7-C	Transite Panel Board – Gray	Chalkboards – Thrift Store, Office 4, Town Manager's Office, Conference Room 1	10% Chrysotile	No	Good	200 SF	CAT II
4-M8-A 4-M8-B 4-M8-C	Sink Acoustical Coating	Town Manager's Office	5% Chrysotile	No	Good	20 SF	CAT II
4-M13-A 4-M13-B 4-M13-C	Window Frame Sealant – Gray, Gummy	Perimeter Exterior Windows Throughout	3% Chrysotile	No	Good	450 SF	CAT II

% = Percent; SF = Square Feet; CAT I = Category I Non-Friable ACM; CAT II = Category II Non-Friable ACM; RACM = Regulated Asbestos Containing Material; ND = Non-detect; VFT=Vinyl Floor Tile; PC=Point Count; PLM=Polarized Light Microscopy; TEM= Transmission Electron Microscopy

Table E-4: Identified ACM Historic Superior High School Campus – Building 5

Summary of Identified ACM Historic Superior High School Campus – Building 5 98 North High School Avenue Superior, Arizona 85173 Survey Dates: July 26 and 27, 2022							
Sample No.	Homogenous Material	Material Location	Asbestos Content	Friable	Condition	Quantity	NESHAP Category
5-M6-A 5-M6-B 5-M6-C	Transite Panel Board	Dining Area/Events (Chalkboard)	8% Chrysotile	No	Good	40 SF	CAT II
5-M9-A 5-M9-B 5-M9-C	Door Frame Sealant – White, Gray	Perimeter Access Doors	15% Chrysotile	No	Good	20 SF	CAT II
5-M10-A 5-M10-B 5-M10-C	Window Frame Sealant – White, Gray	Perimeter Window Frames	10%-15% Chrysotile	No	Good	100 SF	CAT II

% = Percent; SF = Square Feet; CAT I = Category I Non-Friable ACM; CAT II = Category II Non-Friable ACM; RACM = Regulated Asbestos Containing Material; ND = Non-detect

Table E-5: Identified ACM Former Superior High School Campus – Building 6

Summary of Identified ACM Historic Superior High School Campus – Building 6 98 North High School Avenue Superior, Arizona 85173 Survey Date: July 28, 2022							
Sample No.	Homogenous Material	Material Location	Asbestos Content	Friable	Condition	Quantity	NESHAP Category
6-F3-A 6-F3-B 6-F3-C	12"x12" VFT and Mastic – Tan with Red and White Streaks (Under HA-F5)	Lobby and Dispatch Area, Conference Area, Office 3, Holding Area, Office 4	VFT: 2% Chrysotile Mastic: 4% Chrysotile	No	Good	3,000 SF	CAT II
6-F6-A 6-F6-B 6-F6-C	12"x12" VFT and Mastic – White with Gray Mottling (Floor Patch)	Lobby and Dispatch Area, Conference Area	VFT PLM: ND VFT TEM: ND Mastic: 4% Chrysotile	No	Good	30 SF	CAT II
6-M2-A 6-M2-B 6-M2-C	Window Frame Sealant – White	Offices 1, 2, and 4	2% Chrysotile	No	Good	20 SF	CAT II
6-M3-A 6-M3-B 6-M3-C	Duct Sealant – Red	Storage Area (Ventilation System), Automotive Bays	2% Chrysotile	No	Good	50 SF	CAT II
% = Percent; SF = Square Feet; CAT I = Category I Non-Friable ACM; CAT II = Category II Non-Friable ACM; RACM = Regulated Asbestos Containing Material; ND = Non-detect; VFT=Vinyl Floor Tile; PLM=Polarized Light Microscopy; TEM= Transmission Electron Microscopy							

Table E-6: Identified ACM Former Superior High School Campus – Building 7

Summary of Identified ACM Historic Superior High School Campus – Building 7 98 North High School Avenue Superior, Arizona 85173 Survey Date: July 29, 2022							
Sample No.	Homogenous Material	Material Location	Asbestos Content	Friable	Condition	Quantity	NESHAP Category
7-F3-A 7-F3-B 7-F3-C	12"x12" VFT and Mastic – White with Gray Mottling	Northeast Concrete Area	VFT: 2% Chrysotile Mastic: ND	No	Good	50 SF	CAT II
7-F4-A 7-F4-B 7-F4-C	12"x12" VFT and Mastic – Pink with Mottling	Northeast Concrete Area	VFT: 2% Chrysotile Mastic: ND	No	Good	60 SF	CAT II
% = Percent; SF = Square Feet; CAT I = Category I Non-Friable ACM; CAT II = Category II Non-Friable ACM; RACM = Regulated Asbestos Containing Material; ND = Non-detect; VFT=Vinyl Floor Tile							

The results of this Survey indicate that ACM is present within Buildings 1, 3, 4, 5, 6, and 7 and must be removed/abated prior to renovation and/or demolition. After the ACM is removed, the remaining construction waste is considered non-hazardous and may be disposed of in a construction waste landfill.

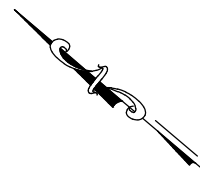

NOT TO SCALE
NOTE: ALL LOCATIONS ARE APPROXIMATE

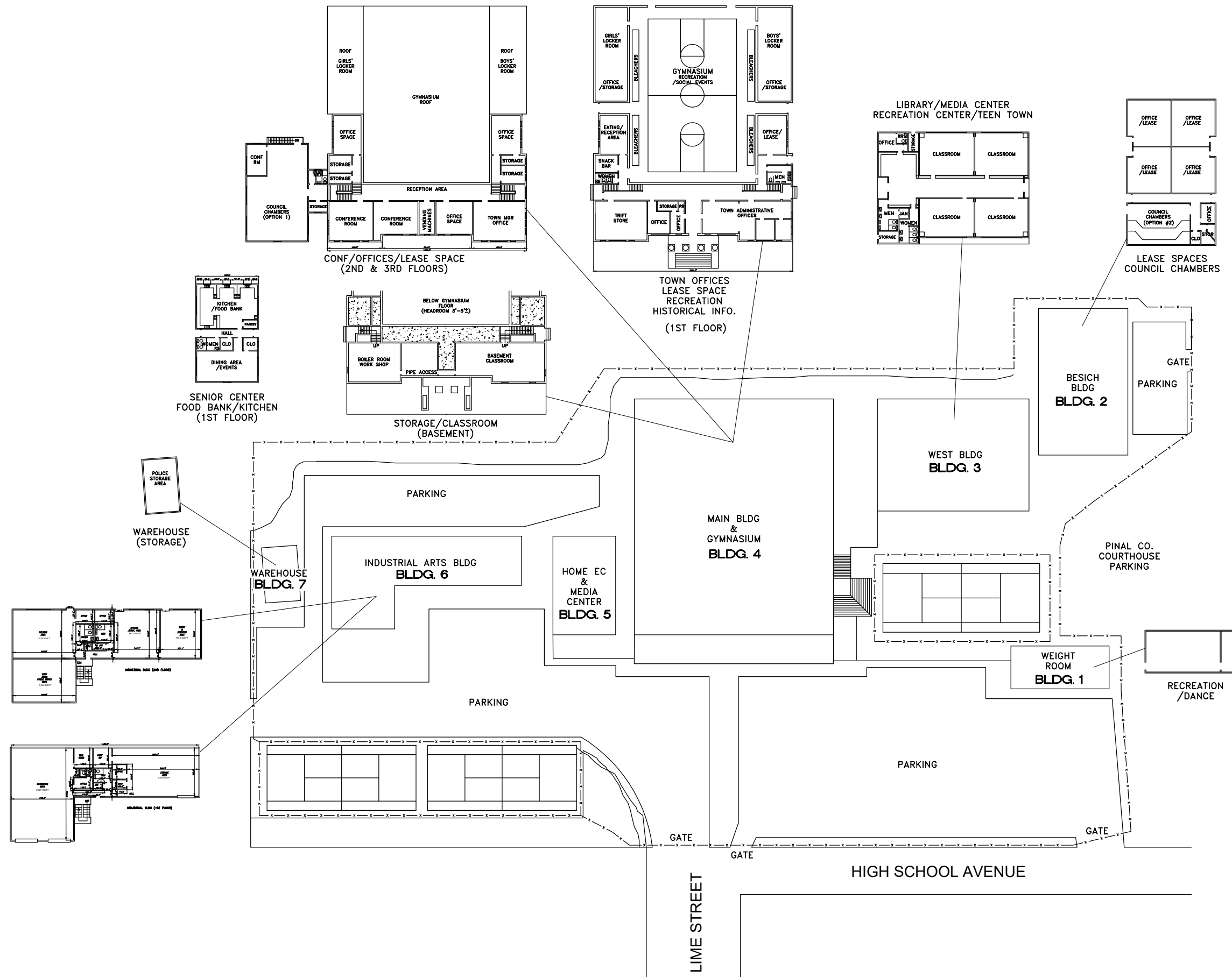

PROJECT NUMBER: 1052000242
 APPROVED BY: TH
 DATE: 9/15/22
 DRAWN BY: BK
 FIGURE 1

ATLAS
 9185 S. Farmer Ave., Ste. #111
 Tempe, Arizona 85284-2912
 Ph: (480) 894-2056 *** Fax: (480) 894-2497

SITE PLAN
 FORMER SUPERIOR HIGH SCHOOL CAMPUS
 98 HIGH SCHOOL AVENUE
 SUPERIOR, AZ 85273